

# SMALL EZ BARRIER

EZ TUBE DISPLAYS

PRODUCT CODE: EZBRRSM



On frame On graphic



Barrier Connector Foot (Optional)

## PRODUCT DESCRIPTION

The new EZ Barrier brings lightweight portability to advertising barrier display systems! Suitable for indoor use, use the EZ Barrier as crowd control at your next trade show or event. Custom printed dye-sub fabric graphic drapes over entire aluminum frame and zips closed. Choose single-sided graphic with black or white backside or double-sided graphic.

Optional: Join together multiple EZ Barriers with Barrier Connector Foot.

DISPLAY DIMENSION	39" W x 35" H x 19.7" D
GRAPHIC DIMENSIONS	42" W x 36" H

## GRAPHIC MATERIAL

Stretch Fabric

## GRAPHIC FINISHING

Sewn left, right, and top with a zipper at the bottom

## DISPLAY CONSTRUCTION

Aluminum Frame

## SHIPPING WEIGHTS & DIMENSIONS

Shipping Weight	17 lbs (frame only) 18 lbs (with graphics)
Shipping Dimensions	24" H x 12.5" W x 5" D

## LARGE QUANTITY FREIGHT

Freight Shipping	48 boxes per 48" L x 40" W x 66" H skids
Freight Weight	816 lbs (frame only) 864 lbs (with graphics)

## GRAPHIC TURN AROUND TIME

2 business days after proof approval

## AVAILABLE ACCESSORIES

Barrier Connector Foot

AVAILABILITY	CA and PA
--------------	-----------



Straight Barrier Connection (Optional)



Corner Connection (Optional)



# SMALL EZ BARRIER

EZ TUBE DISPLAYS

PRODUCT CODE: EZBRRSM

## PARTS LIST



Qty 2 - Curved Tube



Qty 2 - Vertical Tube



Qty 2 - Corner Tube

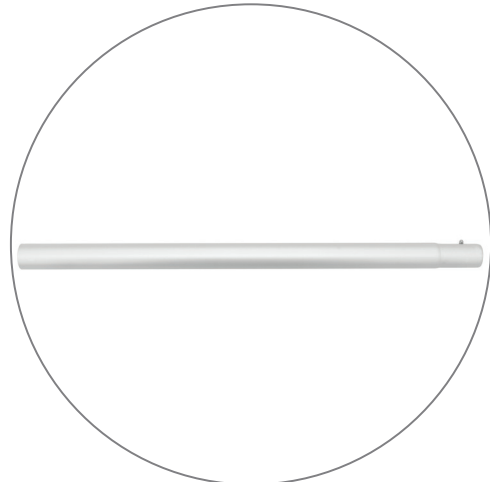

Qty 2 - Horizontal Tube



Qty 2 - Feet  
Dims: 19.7" L x 3" W x .3" H



Qty 2 - Wire Lock Pin



# SMALL EZ BARRIER

EZ TUBE DISPLAYS

PRODUCT CODE: EZBRRSM

## SET UP INSTRUCTIONS

### Set Up Frame

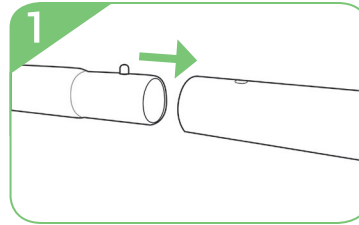
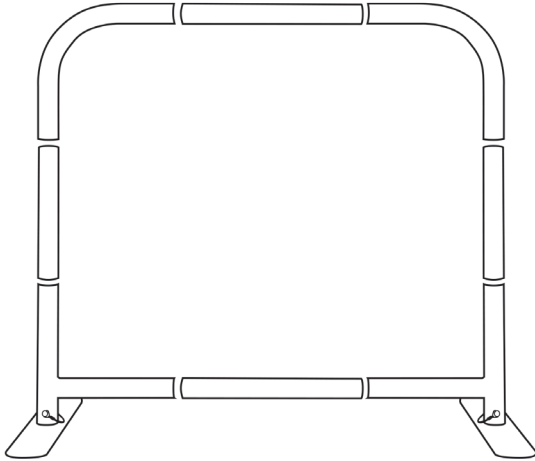

Connect numbered tubes together.

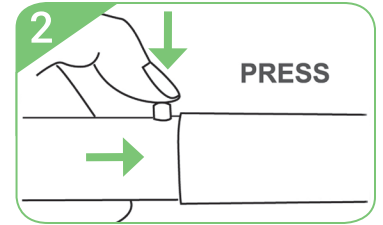

Push down on button and insert tube.

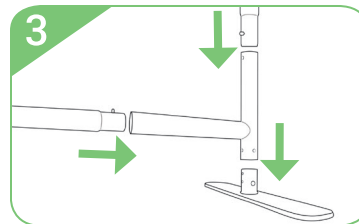

Attach corner tube onto feet.  
Then connect vertical and horizontal  
tubes to complete frame.

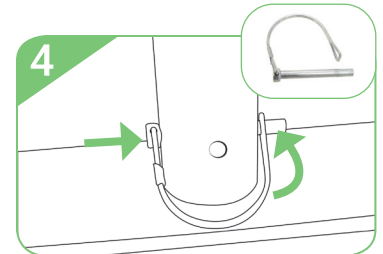

Insert wire lock pin onto the side of  
feet. Then pull wire loop over  
end of the pin to secure feet.

### Install Graphic

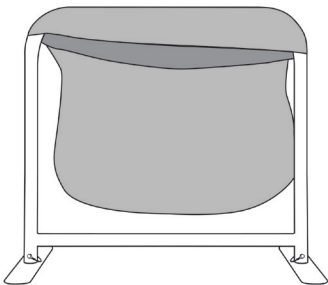

a. Drape graphic over frame.

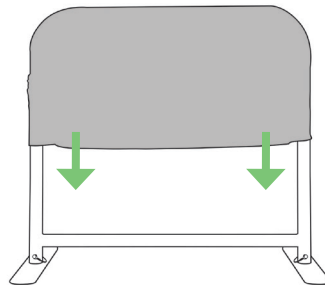

b. Pull down graphic to cover whole frame.



c. Zip underneath the bottom support pole.

### Optional Connection



a. Use barrier connector foot to arrange  
your own combination barrier.



b. Place frames onto barrier connector foot  
and lock with wire lock pins.



c. Arrange barrier either straight or corner.



# SMALL EZ TUBE BARRIER

## SET UP INSTRUCTIONS

### Set Up Frame

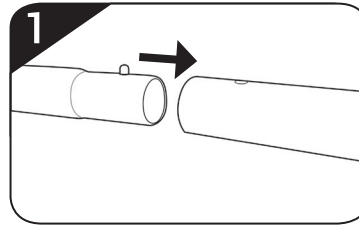
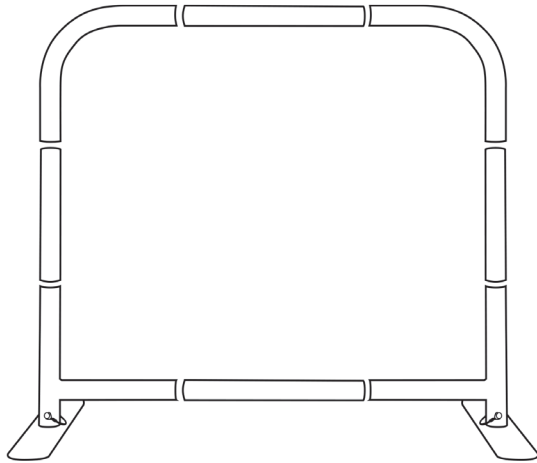

Connect numbered tubes together.

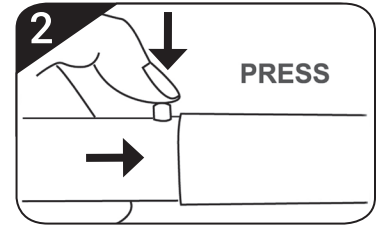

Push down on button and insert tube.

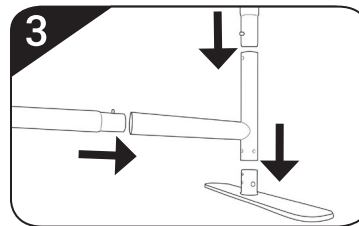

Attach corner tube onto feet.  
Then connect vertical and horizontal  
tubes to complete frame.

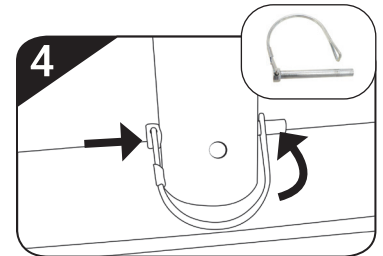

Insert wire lock pin onto the side of  
feet. Then pull wire loop over  
end of the pin to secure feet.

### Install Graphic

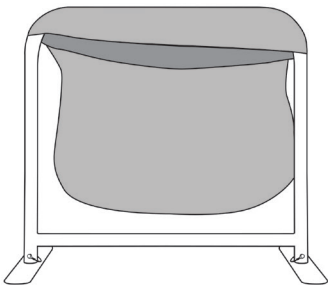

a. Drape graphic over frame.

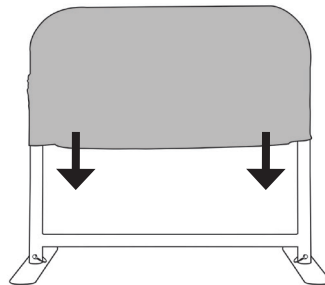

b. Pull down graphic to cover whole frame.



c. Zip underneath the bottom support pole.

### Optional Connection



a. Use barrier connector foot to arrange  
your own combination barrier.



b. Place frames onto barrier connector foot  
and lock with wire lock pins.



c. Arrange barrier either straight or corner.